

FLOORTEK

Glueless SPC/WPC Installation Instructions- Pressed Bevel Wood Designs

⚠ WARNING

post installation temperature must be maintained between 60F to 100F, relative humidity must be maintained between 35% to 70%

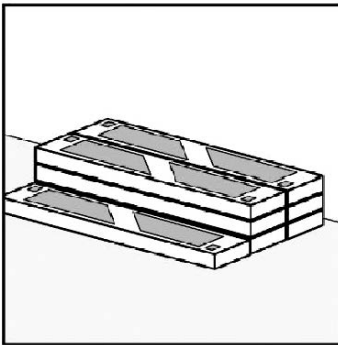

1. DO NOT store cartons near heating / cooling ducts or direct sunlight



2. Undercut door jams for a professional fit. Doorways less than 6' wide require T-Molding

Tools Required

Broom, Electric saw (carbide blade), Eyes and ear protection, Glue, Hammer, Painter's tape, Pencil, Pull bar, straight edge (6ft), Tape Measure, Utility Knife, Wall Spacers (1/4"), Wood Chisel.

Preparation

Glueless SPC can be installed directly over 'most' existing floor coverings except for carpet Wood flooring

Acclimation

- No acclimation period is required when installation but site conditions must be climate controlled prior to and during installation of Floortek SPC/WPC floor.
- During the installation period, temperature should be maintained between 65F to 85F and relative humidity should be between 35% to 65%.
- Do not store cartons near heating/cooling ducts or under direct sunlight.

Subfloor Preparation

- Fill any low spots in the subfloor greater than 1/8" in 6ft check this by using a 6' straight edge. Remove any high spots by sanding or grinding.
- Remove any existing floor molding except the wall baseboards.
- To undercut door frame, lay a loose plank upside down against the frame and on top of the underlayment. This will be your guide for proper height to allow installed planks to float under the door frame. Saw the bottom of the door jamb case bolting back to the wall stud so that 1/4" expansion gap is maintained when SPC/WPC is fitted under door jamb case molding.
- Sweep the subfloor clean.

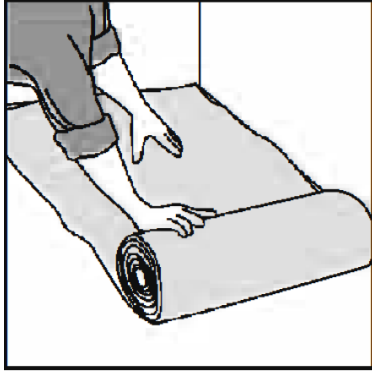

Roll out just enough underlayment for the next few rows of planks you are installing.

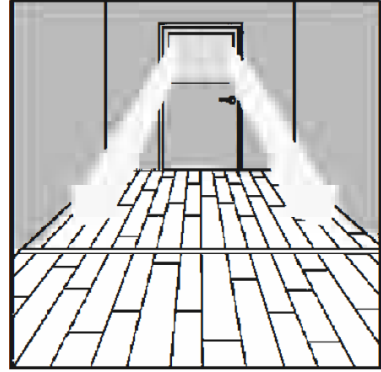

Try to run the planks parallel to main light source. T-molding is only required for rooms more than 1040 sqft

- Unroll one width of underlayment along the longest wall. Always work from left to right. Planks should run lengthwise against the longest wall, and if possible, parallel to incoming sunlight
- Rooms larger than 26 X 40 ft (1040 sqft) requires T-molding for expansion. Floor spans should not exceed 40' in any direction.

Start of Installation

- The width of the first row of planks should be approximately the same width as the last row. This may require cutting the first row plank to a shorter width. Measure across the room (inches) and divide by the width of a plank to see how many full width planks will be used and what size width will be needed for the last row. The last row should never be less than 2" in width.
- Use 1/4" spacers to maintain the proper expansion gap around the entire perimeter of the floor. Quarter round molding will cover this expansion gap. **IMPORTANT:** this 1/4" gap must be maintained around cabinets, pipes toilet flanges and any other obstacles on the floor.

Inspect each board carefully for damage prior to installing it.

- Do not install a damaged plank
- Check groove on plank to make sure it is clean and free of debris.



Begin the installation in the left hand corner against the wall. Place the plank a minimum of 1/4" from the left wall. Use the installation spacers throughout all perimeter area to insure the correct expansion space is maintained.

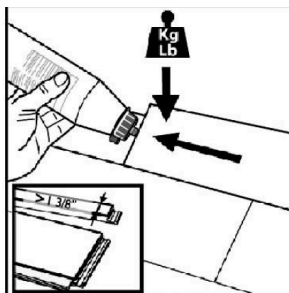

Assemble the starting row of planks by applying a 1/8" bead of tongue and groove adhesive on the bottom groove lip of each END seam plank. Place each plank end firmly into the seam adhesive, position and tape the seams with painter's tape, or weight them down to insure they remain flush while the adhesive sets. Use a clean, soft cloth to carefully clean up any excess adhesive on the surface of the planks.

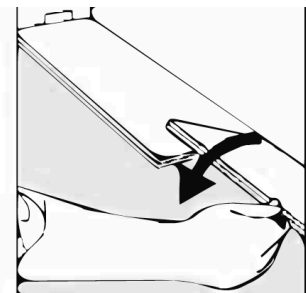
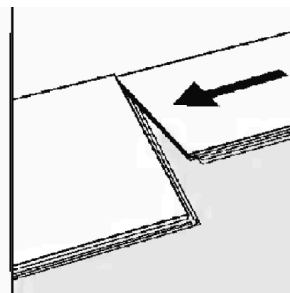

Remember, it is necessary to use adhesive on the end seams of the FIRST and LAST ROWS ONLY! If the end seams of the first row are taped securely, it will not be necessary to wait for the adhesive to fully set before continuing with the set of the installation.

Remainder of the Floor

- **Randomly pull planks from 3 cartons at a time to ensure random appearance.** Use cut pieces from the end of each row as starting planks. Always stagger end joints a minimum of 12", randomly picked pieces will hide repeating patterns for best results.
- **All joints should be a tight fit with no gaps.** Stop and reconnect if a joint is not tighter if all edges are not even with adjacent planks. These planks can be engaged and disengaged several times if needed to help make a correct installation.
- **When cutting the last row of installed planks (keeping the tongue in the same directions as that of the installed planks).** Use the full width of a scrap piece of plank as a guide. Place a pencil next to the edge and trace a line down the planks following the contour of the wall. Cut planks on the pencil line and then connect the last row.

Glueless flooring is designed to stand up to the toughest household conditions. However, to keep it looking its best, follow these simple instructions for protection and care.

Routine Maintenance

- Use acetone/nail polish remover on a clean cloth to clean tough spots such as oil, paint, markers, lipstick, ink or tar. Wipe the area with a damp cloth to remove any remaining residue.
- Regularly sweep, dust or vacuum the floor with the hard floor attachment (no beater bar) to prevent accumulation of dirt and grit that can scratch or dull the floor finish.
- Do not wash or wet mop the floor with soap, water, oil soap detergent or any other liquid cleaning material. This could cause swelling, warping, delamination, and joint line separation. And void the warranty.
- Do not use steel wool, abrasive cleaners, or strong ammoniated or chlorinated type cleaners.
- Do not use any type of buffing or polishing machine.
- For spot such as candle wax or chewing gum, Harden the spot with ice and then gently scrape with a plastic scrapper such as a credit card. Be careful not to scratch the flooring surface. Wipe clean with a damp cloth.
- Entry mats will help collect dirt, sand, grit and other substances such as oil, asphalt, or driveway sealer that might otherwise be tracked onto your floor.
- To prevent slippage of area rugs, use an approved vinyl rug underlayment.
- Use floor protector and use wide load bearing leg bases/rollers to minimize the chance of indentations and scratches from heavy objects. As a rule, the heavier the object, the wider the floor protector.
- To minimize the natural expansion and contraction of the wood. Maintain a normal indoor relative humidity level between 35% to 65% throughout the year. Heating season (Dry): A humidifier is recommended to prevent excess shrinkage due to low humidifier levels. Wood stove and electric heat tend to create very dry conditions.
- Non heating season (Wet): An air conditioner, dehumidifier, or periodically turning on your heating will help to maintain humidity levels during summer months.

- Keep your pets nails trimmed to prevent them from scratching your floor.
- Never try to slide heavy objects across the floor.
- A protective mat should be used under furniture or chairs with casters/ wheels.

Glueless WPC Board Replacement Repairs:

- May be assembled and disassembled several times.
- Carefully disassembled glueless joints will retain their original locking integrity during reassembly. New replacement planks should be acclimated in the replacement area for at least 72 hours. This allow them to equalize to the conditions of the flooring in the room where the replacements will take place.
- To replace the damaged boards, first remove baseboard, wall base, or quarter road as needed. Take the flooring apart one row at a time. Lift each row to detach, then separate the individual boards.
- Be sure to stack the individual planks in the proper order for re-installation this usually eliminates the need to cut planks for starter end of the row lengths.
- For best visual results, replace the damaged board with a piece from the edge of the original installation.
- Insert the properly acclimated new planks along the outer edge of the original flooring installation during reassembly. This practice minimizes the chance that a newer plank will stand out from the original installation.
- Reinstall the baseboard, wall base, or quarter round, and the replacement repairs complete.

Important Notice

- If you notice both planks aren't at the same height or are not well locked together, please follow the disassembling instructions below, disassemble and check if any debris stuck inside the lock is obstructing. Failure to properly line up the end joint and attempting to force it in while out of alignment could result in permanent.

Disassembling

Separate the whole row by lifting it up delicately at an angle. To separate the plank, leave them flat on the ground and slide out the plank. do not attempt to separate the plank by lifting up the plank. This could result in permanent damage to the end joint.